

ViewPro

4G Dashcam

User Manual V1.4

Please read this manual carefully prior to use. The content of this manual may change due to improvement in performance without prior notice.

CONTENTS

1 Introduction

| | |
|-------------------------------|----|
| 1.1 Packing List ----- | 01 |
| 1.2 Overview ----- | 02 |
| 1.3 Appearance and LEDs ----- | 02 |
| 1.4 Wirings ----- | 05 |

2 Specifications and Features

| | |
|--------------------------|----|
| 2.1 Specifications ----- | 06 |
| 2.2 Features ----- | 07 |

3 Installation

| | |
|---------------------------------------|----|
| 3.1 Preparation ----- | 08 |
| 3.2 SIM Card Attachment ----- | 08 |
| 3.3 TF Card Attachment ----- | 09 |
| 3.4 Main Unit Installation ----- | 10 |
| 3.5 Installation of Accessories ----- | 11 |
| 3.6 Commissioning ----- | 13 |

4 Platform Operations

| | |
|---------------------------|----|
| 4.1 Installation ----- | 15 |
| 4.2 Operation Guide ----- | 15 |

5 FCC Compliance Statements

Introduction

1.1 Packing List

Standard

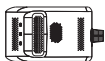

ViewPro

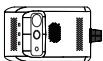

ViewPro+

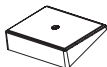

Bracket (for sedans)



Power bundle

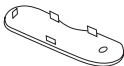

Tamper cover

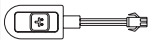

External SOS key



Philips screwdriver



Screws



Relay

Optional



Tamper lock

Bracket
(for heavy-duty trucks)Bracket
(for medium-duty trucks)Simple Version
Power Cable

- Please check the product model you purchased carefully as the packing list varies with the model.

1.2 Overview

- The ViewPro series uses 4G network for communication. For these dual-channel digital video recorders (DVRs), except to be able to record simultaneously, the two cameras can also record locally and live stream remotely at the same time. A number of safety features are included in the system, including DMS, ADAS, exception alerts, and more.
- Furthermore, the 4G capability of the device enables seamless video streaming, live audio alerts, rapid data upload, route replay, and video history playback. With all of these features, fleet managers can coach drivers based on data and improve operations to unlock more benefits, whether they're managing government, logistics, ride-hailing, or taxi fleets.

1.3 Appearance and LEDs

1.3.1 Main Unit

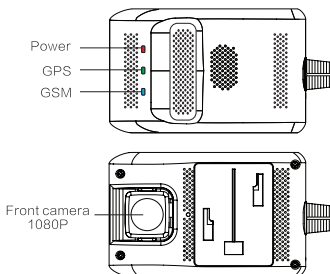

| | |
|---------------|----------------------------------|
| Product Model | ViewPro main unit |
| Camera | 1920x1080/25FPS/F 2.2/Full color |

1.3.2 Subcamera Options

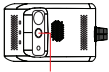
| Product Model | ViewPro+ | Integrated Version |
|---------------|--|---|
| Camera | 1280x720/15FPS/F2.5/Full color in daytime and monochrome in dim light No remote camera |  |
| Usage | Monitor the cabin | |

| Product Model | ViewPro | Remote Cabin-view Version |
|---------------|--|---|
| Camera | 1280x720/15FPS/F2.0/ Full color in daytime and monochrome in dim light |  |
| Usage | Monitor the cabin | |

| Product Model | ViewPro | JC170 DMS Camera |
|---------------|------------------------------------|---|
| Camera | 1280x720/10FPS/ monochrome all day |  |
| Usage | Monitor the Driver | |

- Refer to the specifications and features of the product model you purchased. If you have any questions, please contact your supplier.

1.3.3 LEDs

| LED | Color | Connotación | Estatus |
|---------|-------|-----------------------------|--|
| Power | Red | Solid on | Device power on |
| | | On for 0.5s and off for 10s | Device in sleep mode |
| | | On for 1s and off for 1s | No TF card detected or TF card damaged |
| | | Off | No power connected |
| Network | Bule | Solid on | Connection to server succeeded |
| | | On for 5s and off for 1s | GSM and GPRS networks are available, but connection to server failed |
| | | On for 1s and off for 1s | Only GSM network is available |
| | | Off | GSM network is unavailable |
| GNSS | Green | Solid on | Location succeeded |
| | | On for 1s and off for 1s | Device is locating/location failed |

1.4 Wirings

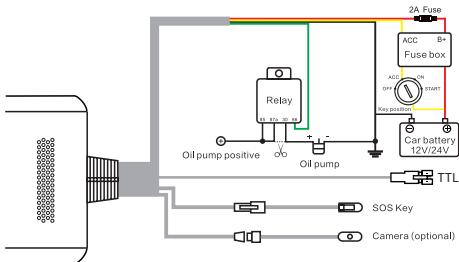

| Cable | Definition | Color | Usage |
|-------------------|---------------|--------|---|
| Power | B+ | Red | To battery positive (9-30V), power input |
| | GND | Black | To battery negative, power input |
| | ACC | Yellow | To ACC ON/Positive (9~30V), power input |
| | Relay | Green | To relay for remote power and fuel cutoff |
| TTL (optional) | I/O | / | To peripherals, such as oil sensor, card reader, etc. |
| SOS | SOS | / | To the external SOS key |
| Camera (optional) | Remote camera | / | Monitor the cabin ViewPro+ can not use this wire |

Specifications and Features

2.1 Specifications

| Category | Item | Parameter | Remarks |
|-------------------|-----------------------|--------------|---|
| Hardware | Memory | 1GB+16GB | / |
| | Standard version | 4G | FDD: B1/B3/B5/B7/B8/B19/B20 TDD: B38/B39/B40/B41 |
| | | 3G | WCDMA: B1/B2/B5/B8 |
| | | 2G | GSM: 850/900/1800/1900 |
| | American Version | 4G | FDD: B2/B4/B5/B7/B12/B17 TDD: B38/B41 |
| | | 3G | WCDMA: B2/B4/B5 |
| | | 2G | GSM: 850/1900 |
| | WiFi | 2.4GHz | 802.11/b/g/n |
| | GNSS | Support | GPS/BDS |
| | Microphone | Support | For remote voice communication |
| | Speaker | Support | To notify drivers of status or events |
| Interface/ Key | Reset key | Support | On the main unit |
| | Interface | Micro USB | For commissioning and upgrade |
| Others | Power supply | Fuse box | B+/ACC/GND |
| | Supply voltage | DC 9-30V | / |
| | Operating temperature | -20°C ~ 65°C | / |

2.2 Features

| No. | Feature | Description |
|-----|-----------------|--|
| 1 | Video recording | This enables the device to record in loop when the vehicle is moving. |
| 2 | Live video | This enables the device to live stream images captured by cameras via the LTE network to the platform (web or app). |
| 3 | Tracking | This enables the device to upload location data and motion information via the mobile network to the platform for analysis. |
| 4 | Event alert | This enables the device to upload alert messages and video files to the platform when an event is triggered by collision, vibration, dangerous driving behavior, emergency, DMS reminder, speeding, etc. |
| 5 | SOS call | This enables the driver to notify the platform at the earliest time possible, make a call, and activate video recording when an emergency occurs. |
| 6 | Remote control | This enables the user to deliver a lock command to the device via the platform (web or app) to remotely cutoff the fuel and power to the vehicle when an exception occurs. |

Note:

For details about features, refer to the operation guide.

Installation

Precautions:

- This device is not suitable for battery electric vehicles (BEVs) and hybrid electric vehicles (HEVs).
- Use accessories specified by the manufacturer only.
- The standard supply for the device is DC9-30V, please use the original power cable and ensure that the positive and negative ends are correctly wired.
- Remove the protective film on the remote camera prior to installation.
- It is recommended to ask a distributor, a designated business, or an expert to do the installation and commissioning.

3.1 Preparation

Device check

- Check visually whether the device is in good condition and whether the relevant accessories are complete.

3.2 SIM Card Attachment

- Ensure that the device is ACC OFF before attaching a proper SIM card. In addition, the SIM should have data service activated and not in arrears.

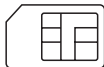

Micro



Nano

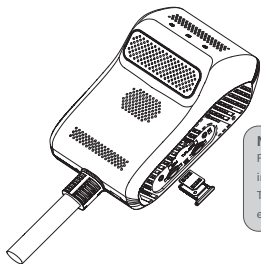

**Note:**

Fit the Nano-SIM into the tray and insert them into the SIM slot.

To remove the card tray, use the ejector tool.

3.3 TF Card Attachment

- Ensure that the device is ACC OFF before attaching a proper TF card.

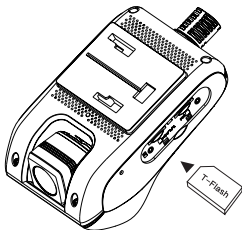
**Note:**

1. Use a TF card in speed class 10 or higher and with a capacity of 32GB or above.
 2. The TF card is recommended to change every half a year to ensure the recording performance of the device.
 3. Mount the tamper cover after the attachment.
- Fit the TF card in the correct slot.

3.4 Main Unit Installation

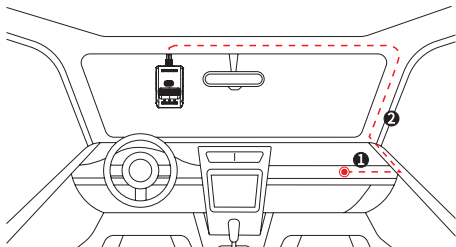

- Connect the power cable of the device to B+, ACC, and GND of the fuse box on the vehicle. ① is a reference position.
- Route the power cable along the A pillar of the vehicle to the upper center of the front windshield. The red dashed line (②) in the figure is for reference.

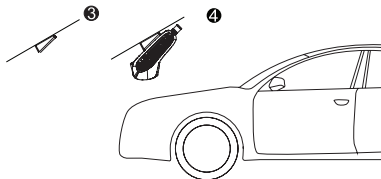

- Select a proper installation position and wipe the position clean. Remove the protective film from the 3M tape of the mounting base and attach it to the position. Wait for 2 hours before proceeding to the next step. See ③ for reference.
- Mount the device to the base and connect its power cable correctly (see ④ for reference). Then fasten the cable securely.

3.5 Installation of Accessories

- You can select a proper position to install the remote camera according to actual conditions.

3.5.1 Remote AHD Camera

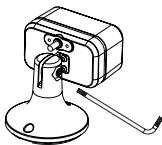
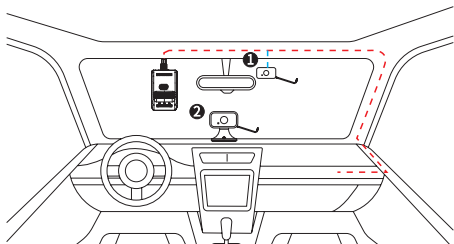

- Face the camera inward and install it to the windshield behind the rear-view mirror (as shown in ①) or to the middle of the dashboard (as shown in ②). Wipe a selected position clean, remove the protective film from the 3M tape, and attach the device.
- Use the supplied screwdriver to tighten the screw of the camera, so it keeps at the best angle. Connect the cables correctly and fasten them securely.

3.5.2 JC170 DMS Camera

- The DMS camera is mainly used for monitoring the driver. Fixate the camera at an angle about 30° to the steering wheel directly facing the driver's head, as the following figure shows.

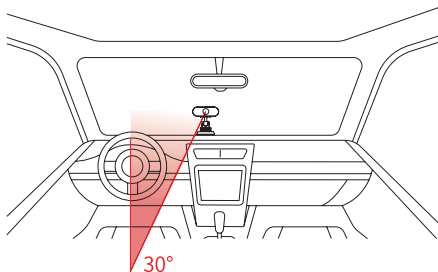

3.5.3 Other Accessories

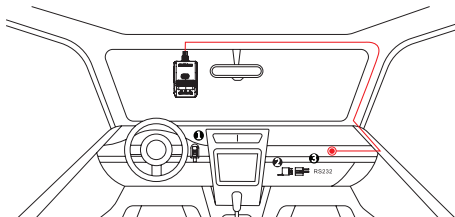

- SOS key

It is used to seek help in emergencies. Connect the SOS key to the corresponding interface on the device, remove the protective film from the 3M tape, and then attach it to a proper position (such as ① in the above figure).

- Relay

It is used to cut off the power and fuel of the vehicle remotely to force it to stop. Connect it to the corresponding interface on the device and place it in a proper position, such as ② in the above figure. For wiring details, see 1.4.

- TTL

It is used to connect to an external device for function expansion when a scenario requires a feature that cannot be offered by the device. ③ is a reference installation position.

Note:

1. Choose proper accessories based on your actual needs.
2. Select a relay that goes perfectly with the battery of your vehicle.
3. It is recommended to ask a distributor, a designated business, or an expert to do the installation and commissioning.

3.6 Commissioning

- Check the LED, see 1.3.3 for reference.

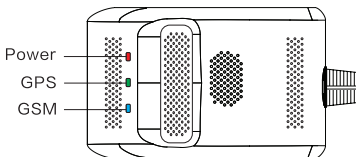

- Check the camera: The camera works correctly if you can view the live video of the camera and switch between the two cameras after logging in to the platform. You can also manually adjust the camera according to your needs.

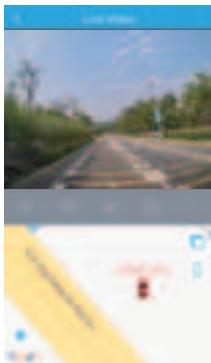

Platform Operations

4.1 Installation

4.1.1 Platform

- Scan the QR code on the right with the browser of your mobile phone to download and install the app.



4.1.1 Configuration Tool

- Scan the QR code on the right with the browser of your mobile phone to download and install the Configuration Tool. This app is used for feature calibration ADAS & DMS and only compatible with mobiles with Android OS.



4.2 Operation Guide

- Scan the QR code on the right with the browser of your mobile phone to view relevant operations.



FCC Compliance Statements

This equipment complies with FCC radiation exposure limits set forth for an uncontrolled environment. This equipment should be installed and operated with minimum distance 20cm between the radiator and your body. This transmitter must not be co-located or operating in conjunction with any other antenna or transmitter.

changes or modifications not expressly approved by the party responsible for compliance could void the user's authority to operate the equipment.

This equipment has been tested and found to comply with the limits for a Class B digital device, pursuant to Part 15 of the FCC Rules. These limits are designed to provide reasonable protection against harmful interference in a residential installation. This equipment generates, uses and can radiate radio frequency energy and, if not installed and used in accordance with the instructions, may cause harmful interference to radio communications. However, there is no guarantee that interference will not occur in a particular installation.

If this equipment does cause harmful interference to radio or television reception, which can be determined by turning the equipment off and on, the user is encouraged to try to correct the interference by one or more of the following measures:

- Reorient or relocate the receiving antenna.
- Increase the separation between the equipment and receiver.
- Connect the equipment into an outlet on a circuit different from that to which the receiver is connected.
- Consult the dealer or an experienced radio/TV technician for help.

RF Exposure Compliance

This equipment complies with FCC radiation exposure limits set forth for an uncontrolled environment. End user must follow the specific operating instructions for satisfying RF exposure compliance. This transmitter must not be co-located or operating in conjunction with any other antenna or transmitter.

This equipment should be installed and operated with minimum distance 20cm between the radiator and your body.